



Yuasa Scheda Tecnica

Yuasa YB10L-BP - YuMicron Batteria

Prestazione

Tensione	12V
Capacità (10 ore)	12Ah
Capacità (20 ore)	12.6Ah
CCA @ -18°C	165A

Dimensioni (±2mm)

Lunghezza	135mm
Profondità	90mm
Altezza	145mm

Pesi e Misure

Peso medio con acido	4kg
Volume dell'acido	0.8l

Tecnologia

Tecnologia	Piastra Sb/Sb
Separatore	Leaf



Schema di Collegamento

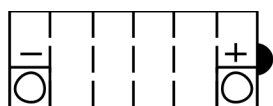

Tipologia dei terminali - 6

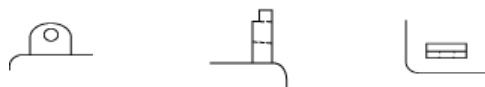

Scheda tecnica prodotta su E&OE



Yuasa Technical Data Sheet

Yuasa YB10L-BP - YuMicron Battery

Performance

Voltage	12V
Capacity (10-hour)	12Ah
Capacity (20-hour)	12.6Ah
CCA @ -18°C	165A

Dimensions (±2mm)

Length	135mm
Width	90mm
Height	145mm

Weights & Measures

Mean Weight with Acid	4kg
Acid Volume	0.8l

Technology

Technology	Cast Sb/Sb
Separator	Leaf



Cell Assembly Layout

Terminal Type - 6

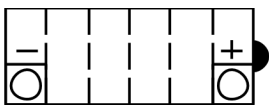

Data Sheet generated on 12/04/2021 - E&OE