



## Yuasa Scheda Tecnica

### Yuasa YB12AL-A2 - YuMicron Batteria

#### Prestazione

Tensione	12V
Capacità (10 ore)	12Ah
Capacità (20 ore)	12.6Ah
CCA @ -18°C	150A

#### Dimensioni (±2mm)

Lunghezza	134mm
Profondità	80mm
Altezza	160mm

#### Pesi e Misure

Peso medio con acido	4kg
Volume dell'acido	0.75l

#### Tecnologia

Tecnologia	Piastra Sb/Sb
Separatore	Synthetic Resin+Glass Fiber



#### Schema di Collegamento

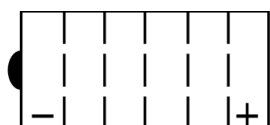

#### Tipologia dei terminali - 6

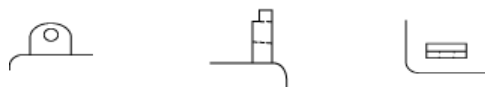

Scheda tecnica prodotta su E&OE



## Yuasa Technical Data Sheet

### Yuasa YB12AL-A2 - YuMicron Battery

#### Performance

Voltage	12V
Capacity (10-hour)	12Ah
Capacity (20-hour)	12.6Ah
CCA @ -18°C	150A

#### Dimensions (±2mm)

Length	134mm
Width	80mm
Height	160mm

#### Weights & Measures

Mean Weight with Acid	4kg
Acid Volume	0.75l

#### Technology

Technology	Cast Sb/Sb
Separator	Synthetic Resin+Glass Fiber



#### Cell Assembly Layout

#### Terminal Type - 6

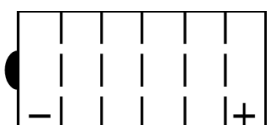

Data Sheet generated on 10/06/2021 - E&OE